

20229050250  
6/21



***Lionel***  
***Plug-Expand-Play<sup>®</sup>***  
***Burning House***  
***Owner's Manual***



## Thank You

**T**hank you for your purchase of the Burning House! The burning house is constructed of injected molded plastic and is operated with a smoke module designed to provide optimal smoke output for a realistic burning effect. Installed red LED lighting simulate a crackling fire within. This accessory is sure to be an instant crowd pleaser on your layout.

**Note!** Be sure that your trains clear the accessory.

## Putting Smoke Fluid in the Smoke Unit

**F**or optimum operation, place the accessory on a flat and level surface on your layout. Access the smoke unit via the hole in the roof of the building. Fill the smoke fluid reservoir with 25-35 drops of smoke fluid. **DO NOT EXCEED** the 35 drops as this can cause your smoke unit to become oversaturated allowing leakage as well as poor smoke performance.

**Note!** For best results, we recommend you use only Lionel Premium Smoke Fluid (6-83280) in your smoke unit.

**Note!** Overfilling the smoke reservoir will cause permanent damage to your accessory that may void the warranty.

**Note!** Operating your burning house's smoke unit without smoke fluid will cause the heating element to burn up. Make sure that the switch is in the OFF position when not running the smoke.

**Caution!** The surface area of smoke module is hot. Allow to cool before touching module.

Your smoke unit is equipped with a LOW and HIGH setting. Select desired output before operating.

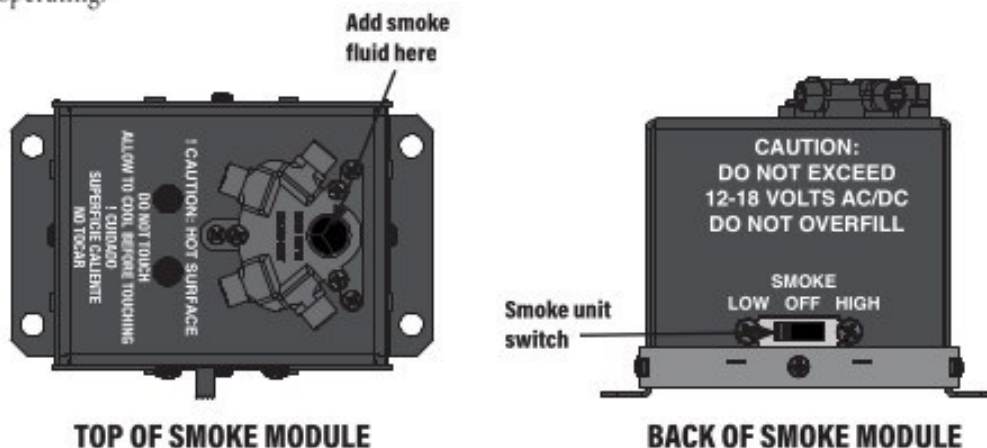

Figure 1. Adding smoke fluid to the smoke module

*The following Lionel marks are used throughout this Owner's Manual and are protected under law. All rights reserved.*

*Lionel, FasTrack, LEGACY, LEGACY Control System, Lockon, TMCC, CAB-1 Remote Controller, Plug-Expand-Play, ASC, Accessory Switch Controller*

### Wiring your accessory to a Plug-Expand-Play lock-on

Your Plug-Expand-Play accessory connects to either a Plug-Expand-Play lock-on (6-81313) or a Plug-Expand-Play power block lock-on (6-81314) with the 3-pin male connector that is attached to its base. Simply plug this connector into the lock-on and apply track power. To turn the accessory OFF, unplug the 3-pin connector from the lock-on or turn off the track power. See figure 2 for wiring.

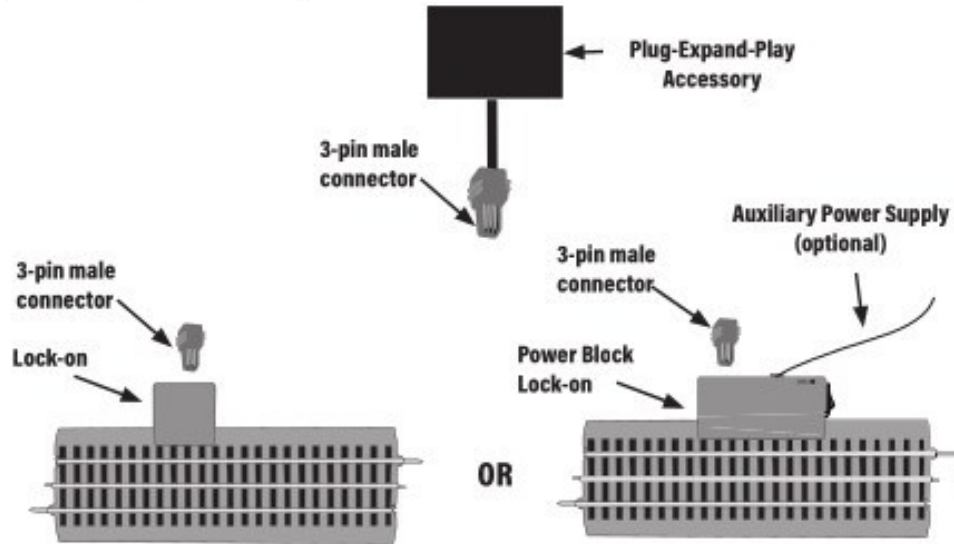

Figure 2. Plug-Expand-Play wiring

### Connecting your accessory to FasTrack and tubular track

You are able to connect your accessory to FasTrack using an 8" 3-pin female pigtail (available separately, 6-82038). Plug in the 3-pin male connector from the accessory into the 3-pin female pigtail. Then attach the red wire to the inside rail and the black wire to the outside rail.

Additionally, you can connect your accessory to tubular track using an 8" 3-pin female pigtail (available separately, 6-82038). Plug in the 3-pin male connector of the accessory into the 3-pin female pigtail. Then attach the red wire to the inside rail position of the universal lock-on (6-24213) and the black wire to the outside rail position.

**Note** The white wire is not used when connecting your accessory to FasTrack or tubular track.

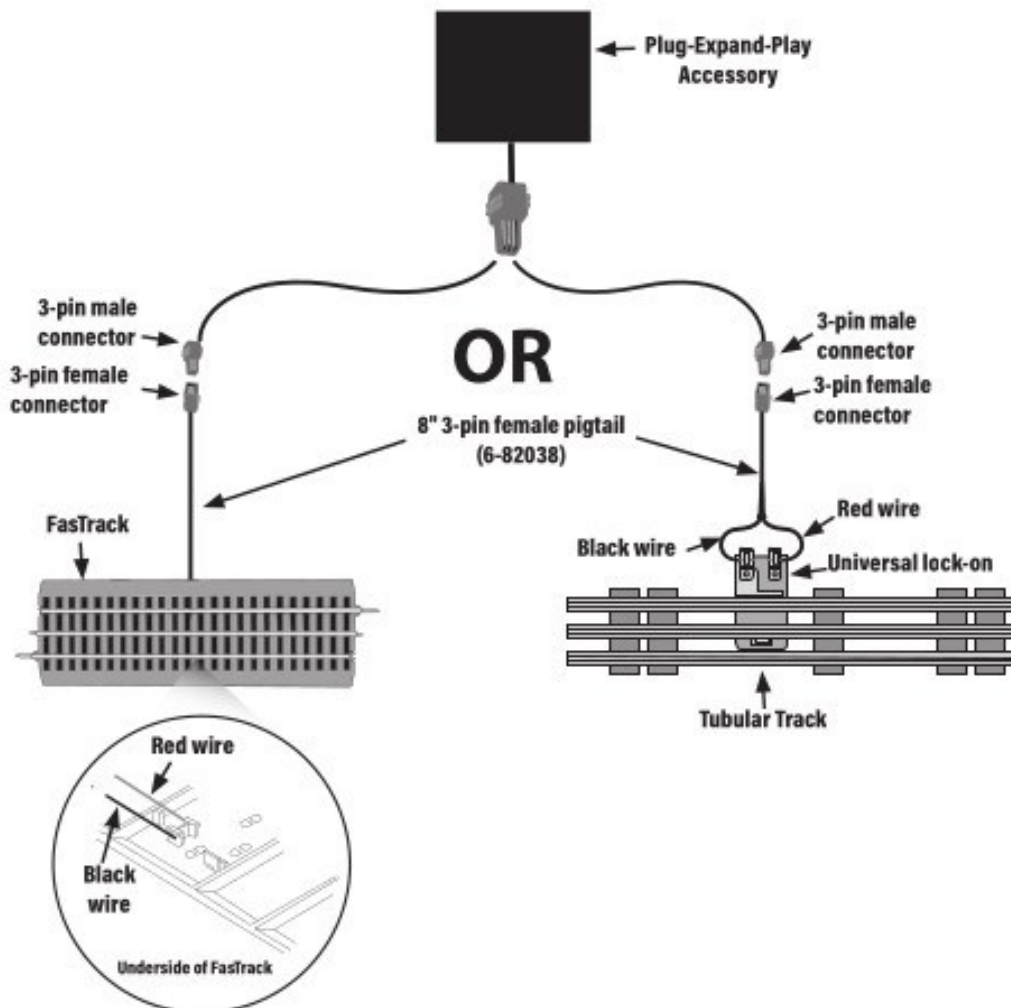

Figure 3. Connecting your accessory to FasTrack and tubular track.

### Connecting your accessory to a transformer

To power your accessory using a CW-80 Transformer (6-14198) or any other power supply, you will need an 8" 3-pin female pigtail (available separately, 6-82038) to connect to the transformer terminals. Make sure that all connections are secure. Loose connections can produce extremely high temperatures. For this reason, do not touch the terminals or track connections during use. Also, do not locate scenery materials such as lichen or ground foam near the terminals.

1. Plug in the 3-pin male connector on the accessory to the 3-pin female slot on the pigtail.
2. Loosen the red ACCESSORY thumbscrew terminal, then place the red wire on the metal terminal bar. Still holding the wire end, tighten the red thumbscrew until secure. Be sure that the wire is touching the metal post.
3. Loosen the black ACCESSORY thumbscrew terminal, then place the black wire on the metal terminal bar. Still holding the wire end, tighten the black thumbscrew until secure. Be sure that the wire is touching the metal post.
4. Plug the CW-80 Transformer into your wall outlet (120 volts).
5. Refer to your CW-80 transformer manual for instructions on how to set the voltage for your accessory output. It is recommended to set it at 14 volts.

**Note!** Do not exceed 18 volts or you will risk damage to your accessory.

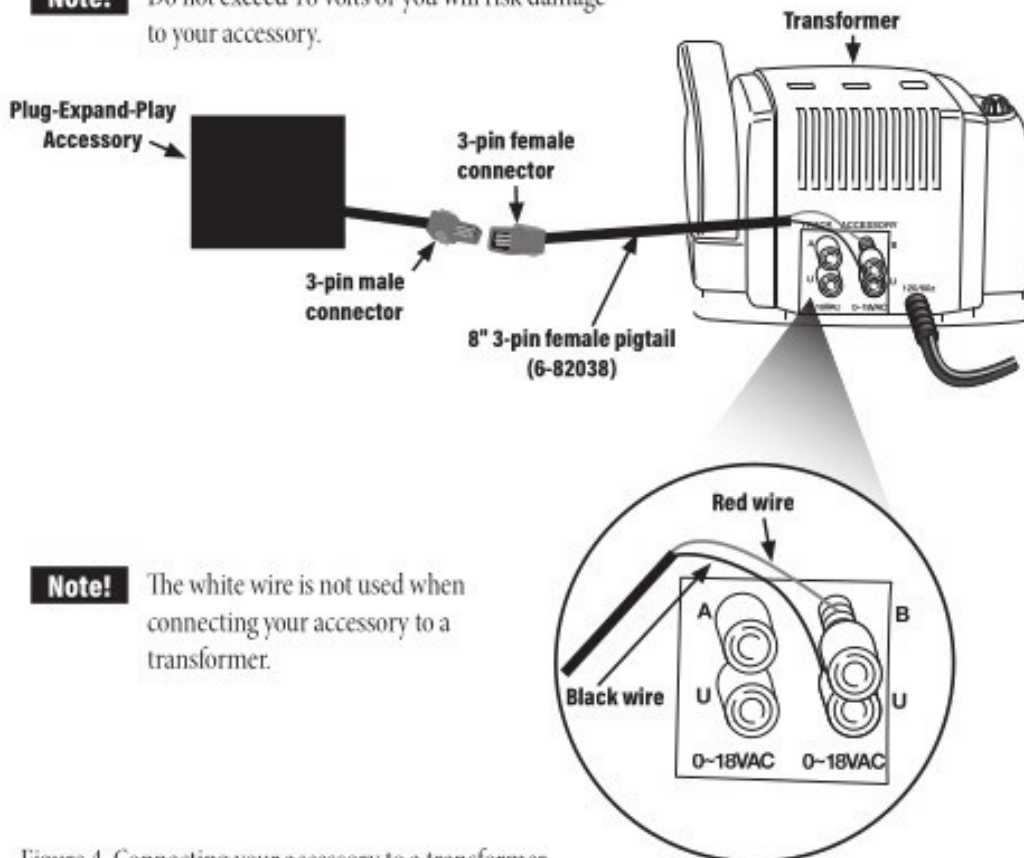

**Note!** The white wire is not used when connecting your accessory to a transformer.

Figure 4. Connecting your accessory to a transformer.

## Wiring for TMCC or LEGACY

To power your accessory in the Command Control and LEGACY environments, you will need an SC-2 (6-22980), an ASC (6-14182), or an ASC2 (6-81639). You will also need an 8" 3-pin female pigtail (available separately, 6-82038) and a transformer (6-14198). See figures 5 and 6 for wiring.

**Note** Refer to your CAB-1, CAB-1L, or LEGACY manual for remote instructions.

### SC-2 wiring and operation

Three wires are needed to connect your accessory to the SC-2 and a separate accessory transformer. Refer to Figure 5.

1. Attach a wire to the transformer Common/Ground/U terminal and connect it to the COMM (common) position on the SC-2.
2. Connect the black wire of the pigtail to the AUX2 terminal on the SC-2.
3. Finally, connect the red wire of the pigtail to the transformer Power/A terminal.

AUX2 will turn the accessory on. The accessory will turn off when AUX2 is released.

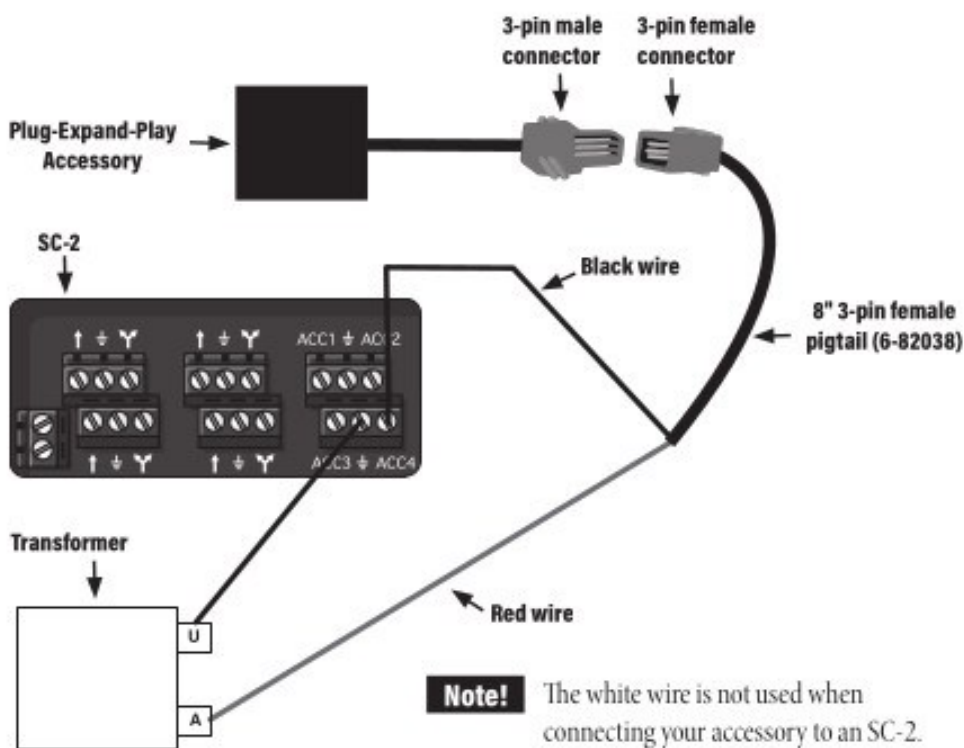

Figure 5. Wiring an SC-2.